

Charlotte Street Pocket Park Draft Concept Plan

July 2023

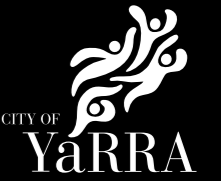

Swan Street

Richmond
Library

Richmond
R.S.L. Building

Charlotte Street

Church Street

Draft concept plan

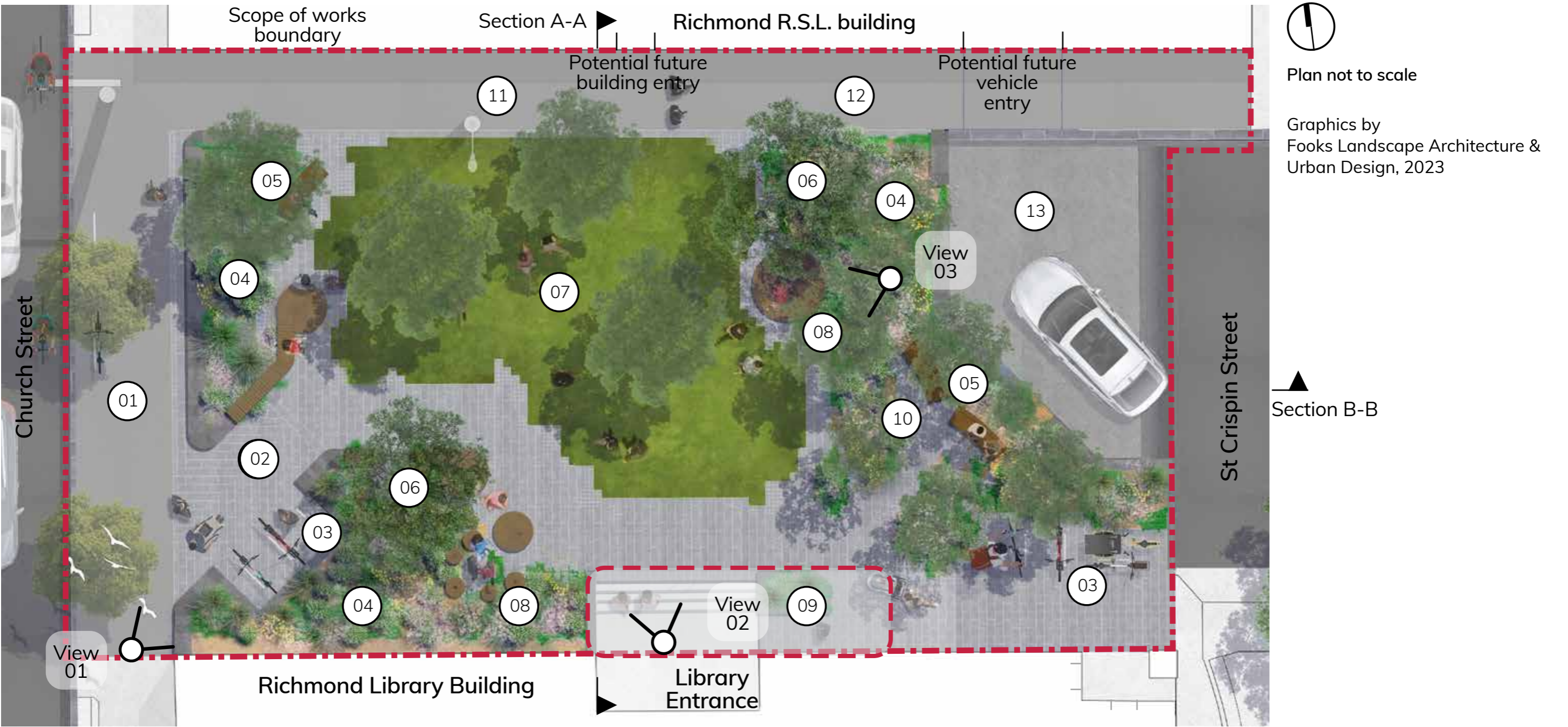

- 01 Footpath (asphalt) connection across Charlotte Street, typically 2.8m wide from back of kerb. Opportunity for tree and bike facilities
- 02 Entrance threshold and path into park and library, framed by stone edges, garden beds and seating elements
- 03 Bike parking facilities
- 04 Garden beds with low growing flowering plants to maintain sight-lines
- 05 Bench seats with back and arm rests
- 06 Existing Pin Oaks proposed to be retained and integrated into the park design
- 07 Main lawn area, with large native canopy trees. Approximately 15x10m
- 08 Groupings of informal seating elements, multi-functional for small groups / story time, stage, or just lounge under trees
- 09 Investigate opportunity to improve building entrance threshold and accessibility
- 10 Tree grove with seating below. Trees with clear trunks to ensure minimum obstruction of sight-lines
- 11 Lighting design will be undertaken in the next design stage. Potential to replace the existing pole light with bespoke park lighting
- 12 Asphalt foot path typically 2.4m wide
- 13 Vehicle access and waste vehicle turning zone

Draft concept sections

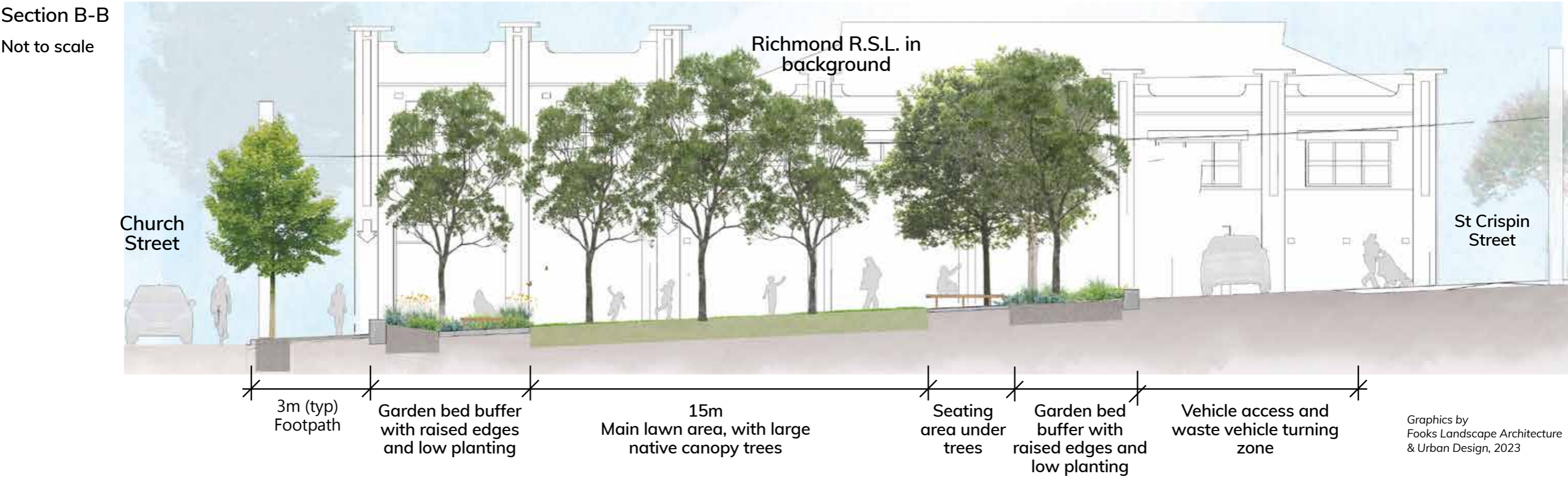
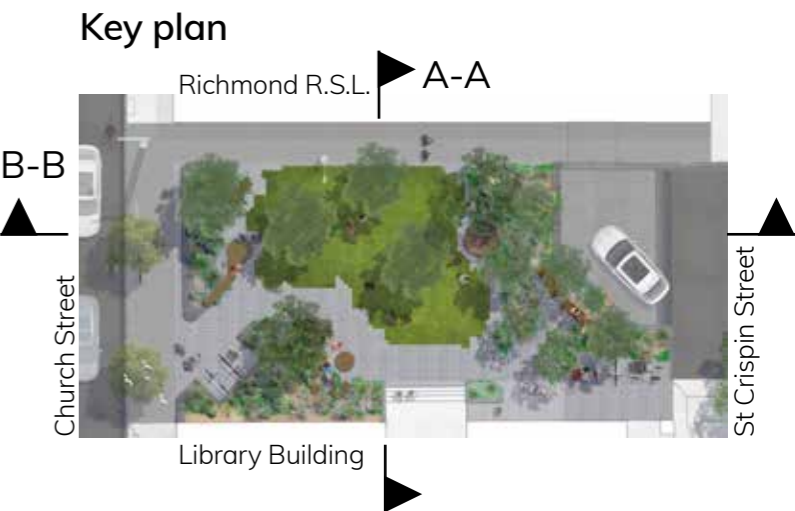
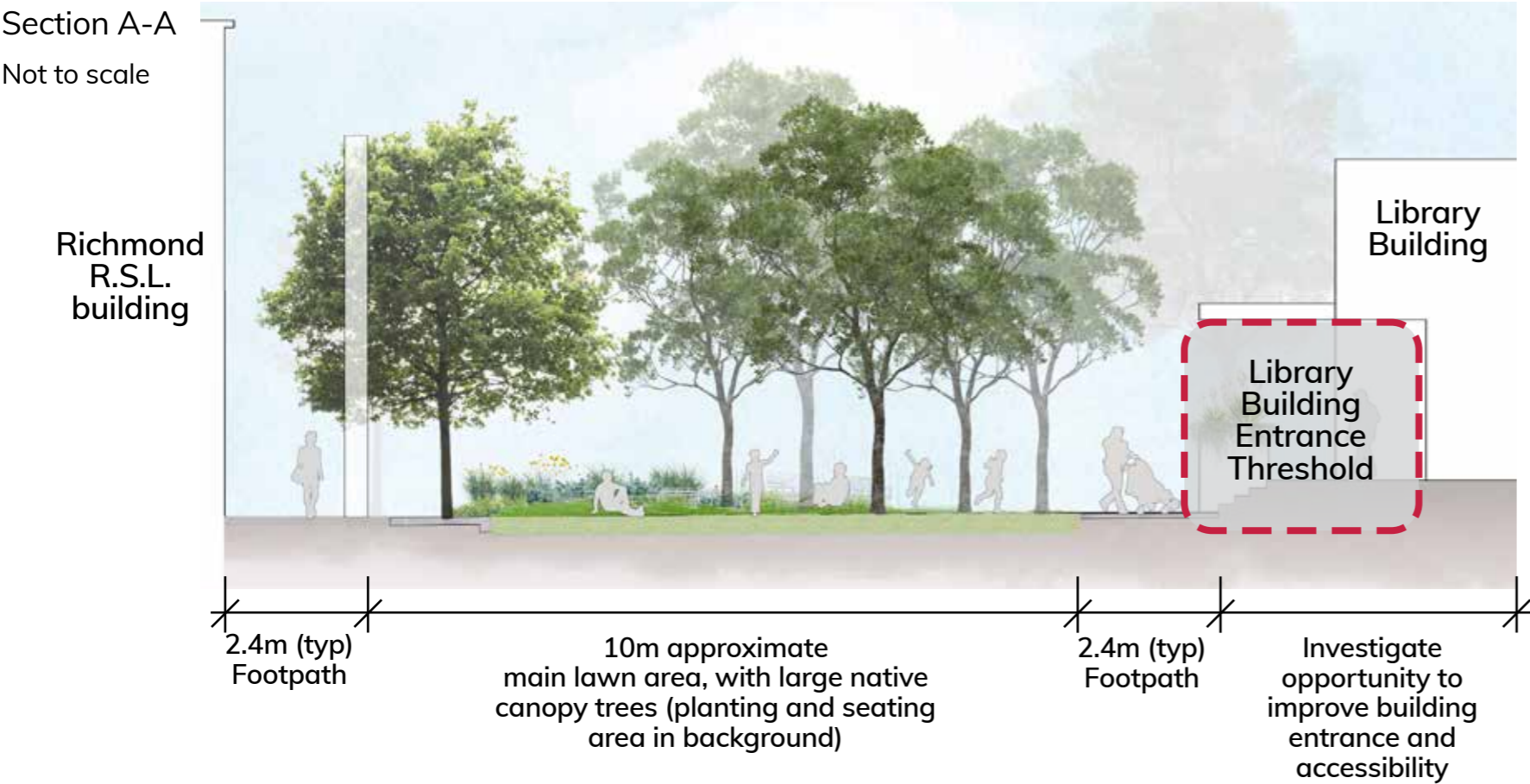

Graphics by
Fooks Landscape Architecture
& Urban Design, 2023

View 01

Looking into the pocket park from Church Street



Key plan



Existing site view



Graphics by
Fooks Landscape Architecture
& Urban Design, 2023

View 02

Looking out over the pocket park from the library building entrance



Key plan



Existing site view



Graphics by
Fooks Landscape Architecture
& Urban Design, 2023

View 03

Looking out over the pocket park from the northeast corner (towards Church Street)



Key plan



Existing site view



Graphics and site images by
Fooks Landscape Architecture
& Urban Design, 2023