

PRECEDENT IMAGES



Bluestone cladding or corten steel raised planter with tree planting.

Pram crossing with bluestone kerb, square sawn bluestone setts and directional signage inlaid into paving.

Sculptural seating / signage to identify Rose Street.

Pyrus nivalis tree planting to match existing street trees and *Lomandra longifolia* 'Lime Tuff' strappy planting.

CONCEPT LAYOUT

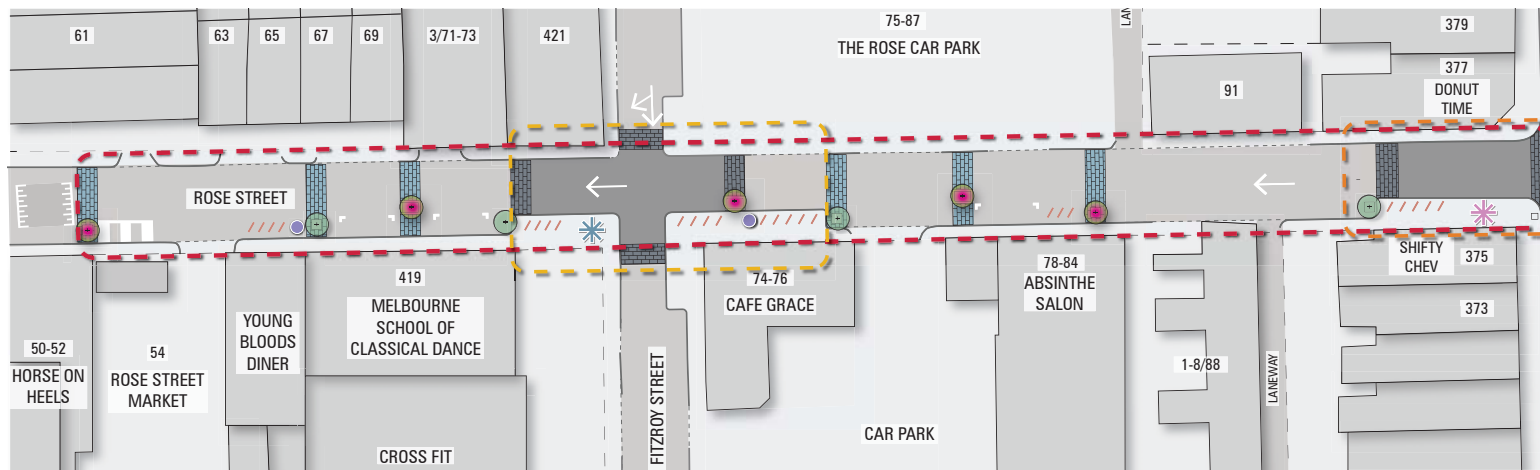

VISUALISATIONS



Intersection of Rose Street and Brunswick Street with proposed gateway element to promote the identity of Rose Street.



Typical arrangement of bluestone paving bands and tree planting in raised beds to provide seating edges.

LEGEND

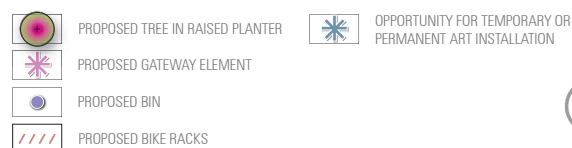
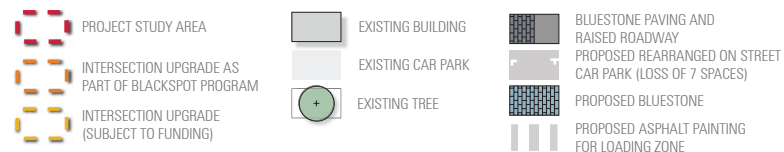

ROSE STREET

CONCEPT OPTION 2: LONG TERM

DESIGN INTENT

Provide a repeating design element to break up the linearity of the street, through tree planting and bluestone paving banding to provide a visual cue to slow vehicles. The design aims to support the change of Rose Street to a shared zone and the priority of pedestrians over vehicle movement.

The design is based on a change from two way traffic flow to be one way traffic flow along Rose Street, from Brunswick Street to Nicholson Street.

DESIGN PRINCIPLES

- Enable better use of Rose Street by people, through provision of spaces which break up the linearity of the road and slow vehicles.
- Treat Rose Street as a priority space for pedestrians and cyclists, not vehicles.
- Provide visual cues to all users that Rose Street is a shared space.
- Respond to the favourable microclimate on the south side of Rose Street.

DESIGN INGREDIENTS

- Shared Zone designation
- Reduced parking
- One way traffic flow
- Bicycle facilities
- Street greening
- Loading zone
- Surface treatment
- Gateway element
- Street furniture

LIMITATIONS

It is acknowledged that there are some functional constraints on the street, identified through site analysis and consultation, which are not able to be addressed due to the limits of the budget for this project.

Job no. 17.033 Drawing no. LCD02 Rev P2

1:250 AT A1 / 1:500 AT A3

